



Simply Plug Them in to Secure Merchandise with an Assortment of Protex Products

Plug-In Sensors

A selection of sensors to protect any consumer electronics device

Protex Plug-In Sensors are the simplest and most reliable security solution that allows open, hands-on demonstrations and sampling of merchandise in a hard-goods environment. The plug-in sensors fit Type-A, Type-B, mini and Firewire

USBs, Air-tool connections, telephone jacks, firewire ports and more. They can be used with the ProLink System, EPA and The Guardian to secure items ranging from telephones, laptops, and computers, to briefcases, luggage, or air tools.

All of the Plug-In sensors come with a 6" straight lead and are used in conjunction with any of the extension cables. The sensor (excluding the Loop Sensor) is plugged directly into the protected item and will trigger an immediate alarm if cut or upon unauthorized removal.

Protex also offers the Loop Sensor (available in varying lengths) that runs through the item's "handle-like" area and plugs back into its own housing, not into the item itself.



Loop Sensors



USB Sensor



Features

- Easily plugged in
- Variety of protection options
- Status-indicator LEDs (excluding the Air-Tool Sensor)

Advantages

- Fast and convenient re-merchandising
- Increased sales associate productivity
- Versatile product applications
- Plugs directly into product port
- Accessible product displays

Plug In Sensors SPECIFICATIONS

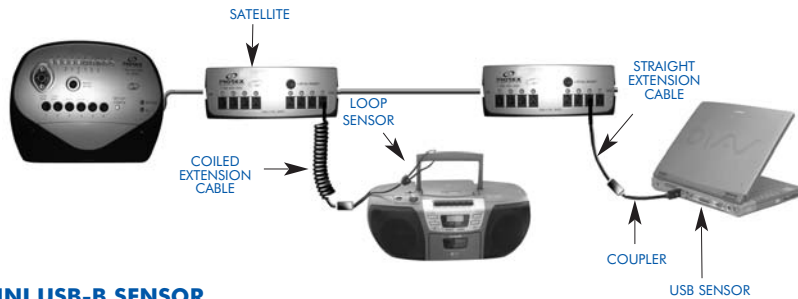

HGS-PL-MUSB-6I

MINI USB-B SENSOR

The Mini-USB-B Sensor is used to protect any peripheral computer device that contains a Mini USB port. The sensor comes with a 6" (15cm) straight lead and does not interfere with the electronic functioning of the item.



HGS-PL-FIRW-6I

FIREWIRE SENSOR

The Firewire Sensor is used to protect laptops, desktops, and camcorders by plugging directly into an available Firewire port. The sensor comes with a 6" (15cm) straight lead and does not interfere with the electronic functioning of the item.



HGS-PL-USB-A-6I

USB-A SENSOR

The USB-A Sensor is used to protect any laptop or desktop computer by plugging directly into an available USB port. The sensor comes with a 6" (15cm) straight lead and does not interfere with the electronic functioning of the item.



HGS-PL-USB-B-6I

USB-B SENSOR

The USB-B Sensor is used to protect any peripheral computer device that contains a USB port. The sensor cable comes with a 6" (15cm) straight lead, plugs directly into the USB port and does not interfere with the electronic functioning of the item.



HGS-PL-TI3-6I

TELEPHONE-END SENSOR

The Telephone-End Sensor is used to protect corded and cordless telephones, answering machines or any product with a telephone jack. The sensor is plugged directly into an available telephone jack.



HGS-PL-LOOP9-00

LOOP SENSOR

The Loop Sensor is used to protect items that have a closed "handle-like" area such as power tools, briefcases, binoculars, portable radios, etc. The cable is run through the item's "handle-like" area and plugged back into its own housing, forming the protective "loop".

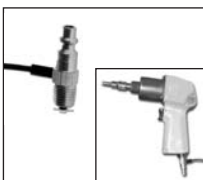

HGS-PL-AIR-6I

AIR-TOOL SENSOR

The Air-Tool Sensor is used to protect all air tools and is screwed directly into the tool's air inlet. The sensor comes with a 6" (15cm) straight lead.



PL-SENS-1/08



Specifications subject to improvement or change without notice. Copyright © 2007 Protex International Corp. Certain product names mentioned herein may be trade names and/or registered trademarks of Protex International Corp. The equipment that you purchased has required the extraction and use of natural resources for its production. It may contain hazardous substances that could impact health and the environment. In order to avoid the dissemination of those substances in our environment and to diminish the pressure on the natural resources, we encourage you to use the appropriate take-back systems. Those systems will reuse or recycle most of the materials of your end life equipment in a sound way. The crossed-out wheeled bin symbol invites you to use those systems. If you need more information on the collection, reuse and recycling systems, please contact your local or regional waste administration. For more information on the WEEE Directive you can visit our web site at www.protex-intl.com.